

601



### South Side / Route 30

Via Midline Rd, Wallins Corners Rd, Rt. 30, and Downtown Amsterdam

EFFECTIVE JANUARY 26, 2025

# Schedule

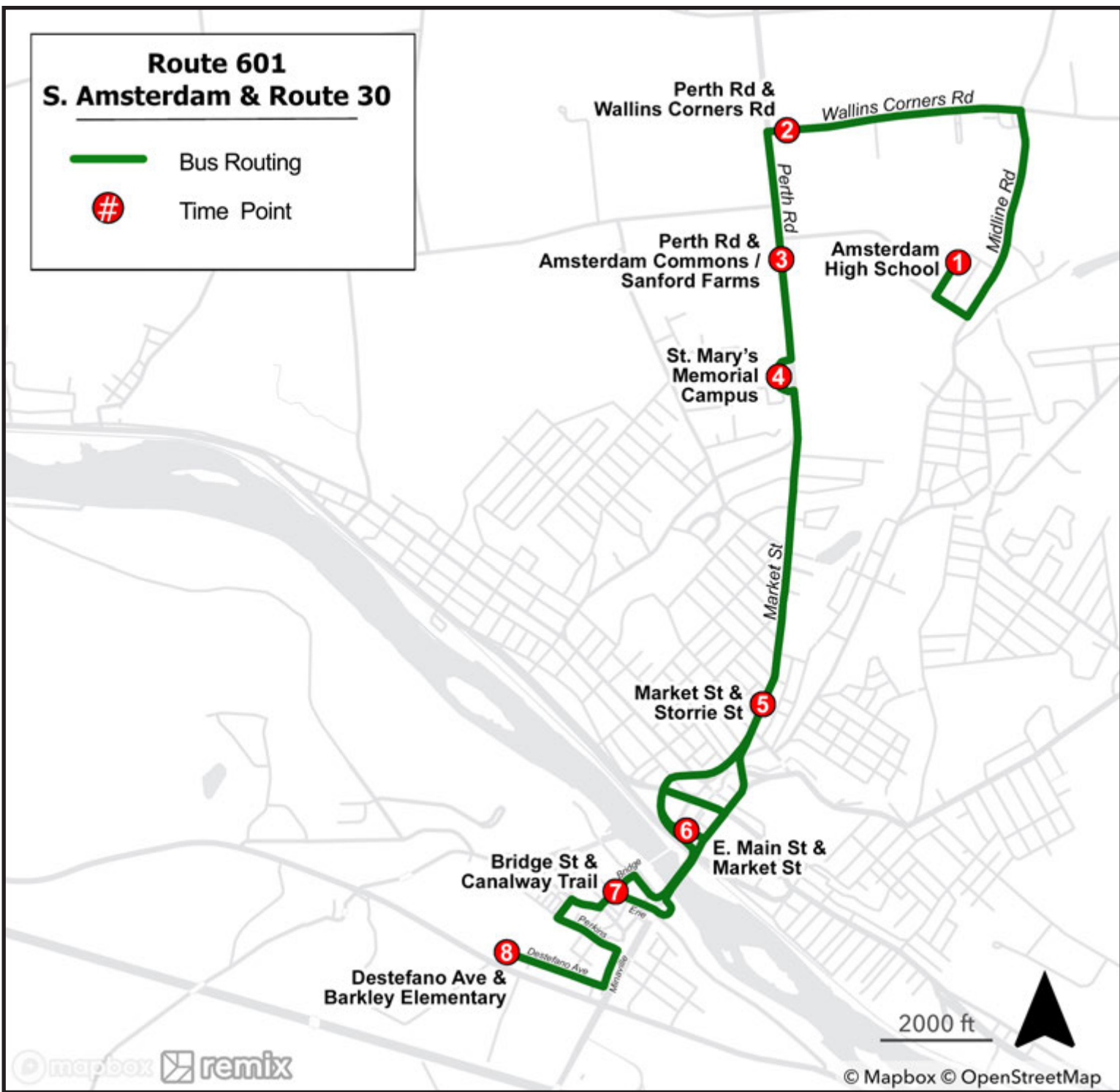

### Southbound

1	2	3	4	5	6	7	8
---	---	---	---	---	---	---	---

Amsterdam High School	Wallins Corners Rd & Lowe's	Perth Rd & Amsterdam Commons	St. Mary's Memorial Campus	Market St & Storrle St.	E. Main St. & Market St.	Bridge St & Canalway Trail	Destefano Ave. & Barkley Elementary School
-----------------------	-----------------------------	------------------------------	----------------------------	-------------------------	--------------------------	----------------------------	--

### MONDAY - FRIDAY

438a	442a	444a	446a	449a	451a	456a	502a
538a	542a	544a	546a	549a	551a	556a	602a
638a	642a	644a	646a	649a	652a	657a	703a
738a	742a	744a	746a	749a	752a	757a	803a
838a	842a	844a	846a	849a	852a	857a	903a
938a	942a	944a	946a	949a	951a	956a	1002a
1038a	1042a	1044a	1046a	1049a	1051a	1056a	1102a
1138a	1142a	1144a	1147a	1150a	1153a	1158a	1204p
1238p	1242p	1244p	1246p	1250p	1252p	1257p	102p
138p	142p	144p	146p	150p	152p	157p	202p
<b>S-236p</b>	<b>S-240p</b>	<b>S-242p</b>	<b>S-244p</b>	<b>S-249p</b>	<b>S-251p</b>	<b>S-257p</b>	<b>S-303p</b>
250p	254p	256p	258p	303p	305p	311p	317p
308p	312p	314p	316p	321p	323p	329p	335p
408p	412p	414p	417p	420p	422p	428p	434p
443p	447p	449p	452p	455p	457p	502p	508p
543p	547p	549p	552p	555p	557p	601p	607p
613p	617p	619p	621p	624p	626p	630p	635p
713p	717p	719p	721p	724p	726p	730p	735p
813p	817p	819p	821p	824p	826p	830p	835p
848p	852p	853p	855p	858p	900p	904p	909p

S = Trip Will Not Run When School Is Not In Session

### Southbound

1	2	3	4	5	6	7	8
---	---	---	---	---	---	---	---

Amsterdam High School	Wallins Corners Rd & Lowe's	Perth Rd & Amsterdam Commons	St. Mary's Memorial Campus	Market St & Storrle St.	E. Main St. & Market St.	Bridge St & Canalway Trail	Destefano Ave. & Barkley Elementary School
-----------------------	-----------------------------	------------------------------	----------------------------	-------------------------	--------------------------	----------------------------	--

### SATURDAY

900a	904a	906a	907a	910a	912a	916a	922a
1020a	1024a	1026a	1027a	1030a	1032a	1036a	1042a
1140a	1144a	1146a	1147a	1150a	1152a	1156a	1202p
100p	104p	106p	108p	111p	113p	117p	123p
220p	224p	226p	228p	231p	233p	237p	243p
340p	344p	346p	348p	351p	353p	357p	403p
500p	504p	506p	507p	510p	512p	516p	522p
620p	624p	626p	627p	630p	632p	636p	642p

### Northbound

8	7	6	5	4	3	2	1
---	---	---	---	---	---	---	---

Destefano Ave. & Barkley Elementary School	Bridge St & Canalway Trail	E. Main St. & Market St.	Market St & Storrle St.	St. Mary's Memorial Campus	Perth Rd. & Sanford Farms	Perth Rd. & Wallins Corners Rd.	Amsterdam High School
--	----------------------------	--------------------------	-------------------------	----------------------------	---------------------------	---------------------------------	-----------------------

### MONDAY - FRIDAY

453a	457a	502a	505a	509a	510a	511a	516a
538a	542a	547a	550a	554a	555a	556a	601a
630a	634a	639a	642a	646a	647a	648a	653a
647a	651a	656a	659a	703a	704a	705a	710a
707a	711a	716a	719a	723a	724a	725a	730a
723a	727a	732a	735a	739a	740a	741a	746a
823a	827a	833a	836a	840a	841a	843a	848a
923a	927a	933a	936a	940a	941a	943a	948a
1023a	1027a	1033a	1036a	1040a	1041a	1043a	1048a
1123a	1127a	1133a	1136a	1140a	1141a	1143a	1148a
1223p	1227p	1233p	1236p	1240p	1241p	1242p	1247p
123p	127p	133p	136p	140p	141p	142p	147p
223p	227p	233p	236p	240p	241p	243p	248p
323p	327p	333p	336p	340p	341p	343p	348p
353p	357p	403p	406p	410p	411p	413p	418p
444p	448p	453p	456p	500p	501p	502p	507p
514p	518p	523p	526p	530p	531p	532p	537p
544p	548p	553p	556p	600p	601p	602p	607p
644p	648p	653p	656p	700p	701p	702p	707p
744p	748p	753p	756p	800p	801p	802p	807p
844p	848p	853p	856p	900p	901p	902p	907p

### Northbound

8	7	6	5	4	3	2	1
---	---	---	---	---	---	---	---

Destefano Ave. & Barkley Elementary School	Bridge St & Canalway Trail	E. Main St. & Market St.	Market St & Storrle St.	St. Mary's Memorial Campus	Perth Rd & Amsterdam Commons	Wallins Corners Rd & Lowe's	Amsterdam High School
--	----------------------------	--------------------------	-------------------------	----------------------------	------------------------------	-----------------------------	-----------------------

### SATURDAY

940a	944a	948a	951a	954a	955a	956a	1002a
1100a	1104a	1108a	1111a	1114a	1115a	1117a	1123a
1220p	1224p	1228p	1231p	1234p	1235p	1237p	1243p
140p	144p	148p	151p	154p	155p	158p	204p
300p	304p	308p	311p	314p	315p	317p	323p
420p	424p	428p	431p	434p	435p	436p	442p
540p	544p	548p	551p	554p	555p	556p	602p

### FARE INFORMATION

Fares (US coins and \$1, \$5 – dollar bills are accepted; fareboxes do not make change)

Cash Fares:

Base Fare	\$1.50
Base Half Fare	\$0.75
BusPlus Fare	\$2.00
BusPlus Half Fare	\$1.00

Navigator Smart Card & Mobile App Fares:

**Pay As You Go Fare** – \$1.30 for each of the first three rides, while the fourth and up are free for the rest of the day.

**Pay As You Go Half Fare** – \$0.65 for each of the first three rides, while the fourth and up are free for the rest of the day.

**Frequent Rider** – \$65 for unlimited rides for 31 consecutive days from the first day of use.

**Frequent Rider Half Fare** – \$32.50 for unlimited rides for 31 consecutive days from the first day of use.

**Children 46” and under** – ride free when accompanied by a fare paying adult.

**Citizens age 65 and over, disabled individuals, Medicare card holder, and veterans** – are entitled to ride for half fare on CDTA's fixed route service. A valid Half Fare Navigator card is required when paying half fare on the bus.

CDTA's policy is to be fully compliant with Title VI of the 1964 Civil Right Act, which states that no one shall be excluded from participation in, denied the benefits of or discriminated against due to race, color, or national origin. Members of public may request information on this policy or file a Title VI complaint through CDTA's website @ www.cdta.org or by calling (518) 482-8822.

The timetable shows **WHEN** the bus stops. Times are approximate and depend upon traffic and weather conditions. Arrive at the bus stop 5 minutes early to avoid missing the bus.